

LAKE ERIE

I.C.L.D. 85 LAKE LEVEL ELEV. = 572.77  
OBSERVED ON 7/1/22 AT 8:00 AM

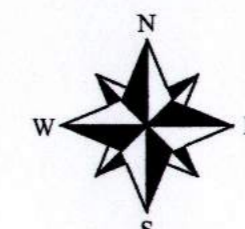

SITUATE:

BEING LANDS SITUATED IN THE CITY OF ROCKY RIVER, COUNTY OF CUYAHOGA AND STATE OF OHIO AND BEING PART OF ORIGINAL ROCKPORT TOWNSHIP SECTION 24 AND ALSO BEING PART OF TOWNSHIP 7 NORTH, RANGE 14 WEST OF THE CONNECTICUT WESTERN RESERVE. ALSO BEING REFERENCED TO BLOCK "B" AND PART OF SUB-LOTS 197-199 OF THE MATHEWS AND GILBERT'S SUBDIVISION NO. 6 IN PLAT VOLUME 37, PAGE 22 & 23 AS RECORDED IN THE CUYAHOGA COUNTY RECORDER'S RECORDS. ALSO BEING A PORTION OF BLOCK "B" HELD IN A DEED OF TRUST DATED MAY 4, 1923 TO DAVID E. CAMPBELL, ETAL. IN VOLUME 2922, PAGE 1 OF THE CUYAHOGA COUNTY RECORDER'S RECORDS.

DATUM:

ALL ELEVATION ARE REFERENCED TO I.C.L.D. 85

LITTORAL DESIGNATIONS:

LITTORAL PROJECTION ON THE WEST IS RADIAL FROM THE INTERSECTION WITH THE NATURAL PER THE 1938 ORTHOPHOTOGRAPHY AND RUN THROUGH THE EASTERLY LINE OF SUB-1478-SU. PROJECTION OF THE SOUTHERLY LINE OF BLOCK "B" P.P.#301-08-004.  
ON THE CENTER IT IS RADIAL FROM THE INTERSECTION WITH THE NATURAL SHORELINE PER THE 1938 ORTHOPHOTOGRAPHY AND RUN THROUGH THE WESTERLY LINE OF BLOCK "B" P.P.#301-08-004.  
ON THE EAST IT IS RADIAL FROM THE INTERSECTION WITH THE NATURAL SHORELINE PER THE 1938 ORTHOPHOTOGRAPHY AND RUN THROUGH THE CENTER OF BLOCK "B" P.P.#301-08-004.

LEGEND:

- ⊙ INDICATES AN EXISTING MONUMENT FOUND AS DESCRIBED
- ⊙ INDICATES A 5/8" IRON PIN WITH IDENTIFICATION CAP MARKED "T.SNEZEK - S-7051" SET

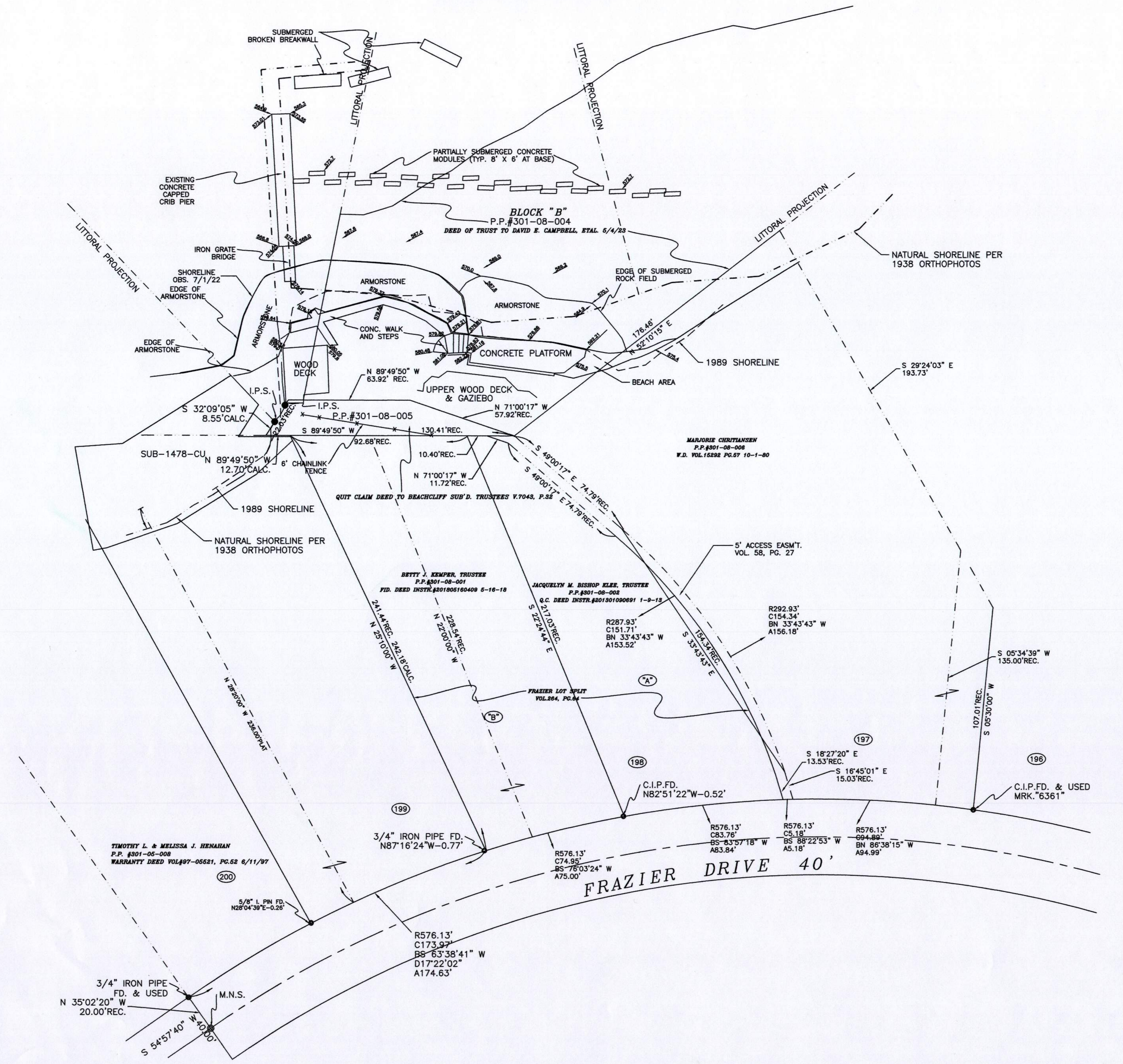

RECORDS USED:

OAKWOOD ON THE LAKE SUB NO. 6 VOL.37, PG.23 3/30/1908  
FRAZIER LOT SPLIT BY REITZ ENGINEERING 9/14/93 V.264, P.64  
MAP OF 5' EASEMENT BY EVERS ENG. CO. 11/21/1916 V.58, P.27  
DEED OF TRUST TO DAVID E. CAMPBELL, ETAL. 5/4/23 V.2922, P.1  
QUIT CLAIM DEED TO BEACHCLIFF SUB'D. TRUSTEES V.7043, P.32  
W.D. TO MARJORIE CHRISTIANSEN V.15292, P.57 10/1/80  
W.D. TO ISABEL B. TROSTLE V.6255, P.349 2/1/47  
1938 ORTHOPHOTOGRAPHY PROVIDED BY O.D.N.R.  
2006 ORTHOPHOTOGRAPHY TAKEN FROM THE CUYAHOGA COUNTY CEGIS

SURVEYOR'S STATEMENT

DISTANCES ARE EXPRESSED IN FEET AND DECIMAL PARTS THEREOF. BASIS OF BEARINGS TAKEN FROM CENTERLINE OF FRAZIER DRIVE ON THE MATHEWS & GILBERT'S SUBDIVISION NO. 6 PLAT VOL. 37, PG. 23. PERMANENT MONUMENTS WERE FOUND OR SET AS INDICATED HEREON. ALL OF WHICH I DECLARE TO BE CORRECT TO THE BEST OF MY ABILITY AND BELIEF.

*Thomas M. Snezek*  
THOMAS M. SNEZEK, P.S. NO. 7051

12/1/23  
DATE

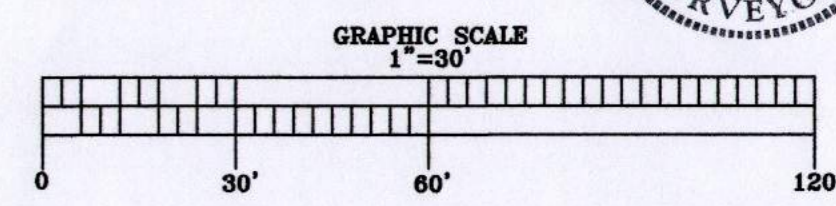
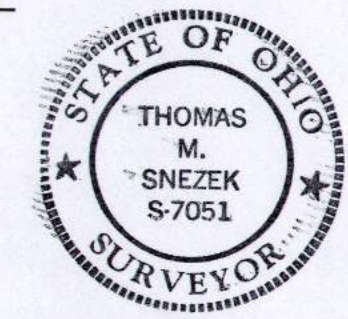

ENGINEERED TECHNICAL SOLUTIONS  
Site Design  
Frostion Control  
Ecological - Utility  
27330 Center Ridge Road  
Westlake, Ohio 44145  
Phone: (440) 899-6890  
www.engineeredtechnical.com

PROJECT:	OAKWOOD BEACH ASSOCIATION
DWG. NO.:	EN-2
ISSUE:	PERMIT
SCALE:	1"=30'
DATE:	12-05-23
DRAWN BY:	T.M.S.
CHECKED BY:	J.A.S.
REVISIONS:	07-01-22
	08-15-23
	12-05-23
LOCATION:	ROCKY RIVER, OH. 44116



05-14-2021

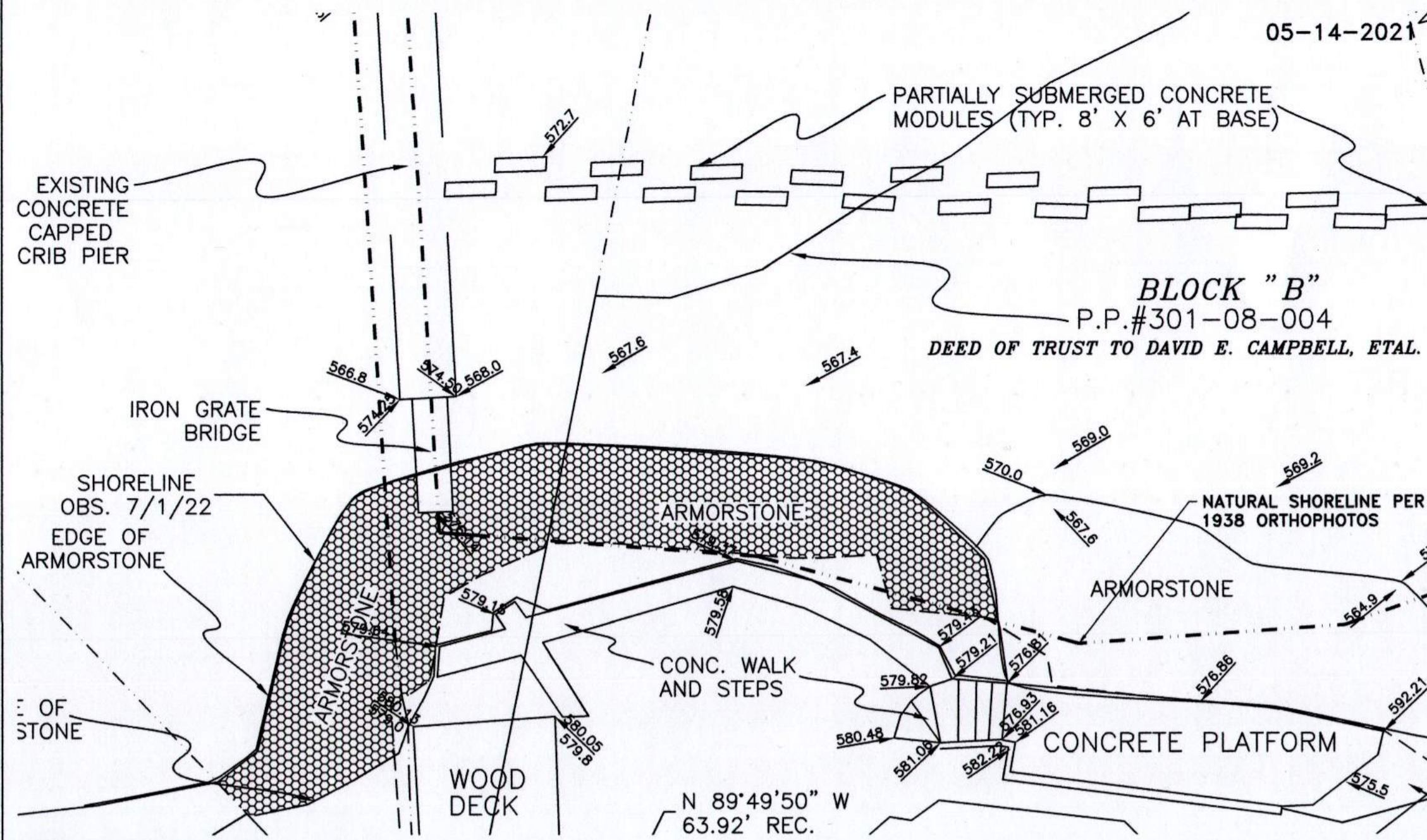

EXISTING PLAN  
SCALE: 1"=20'-0"

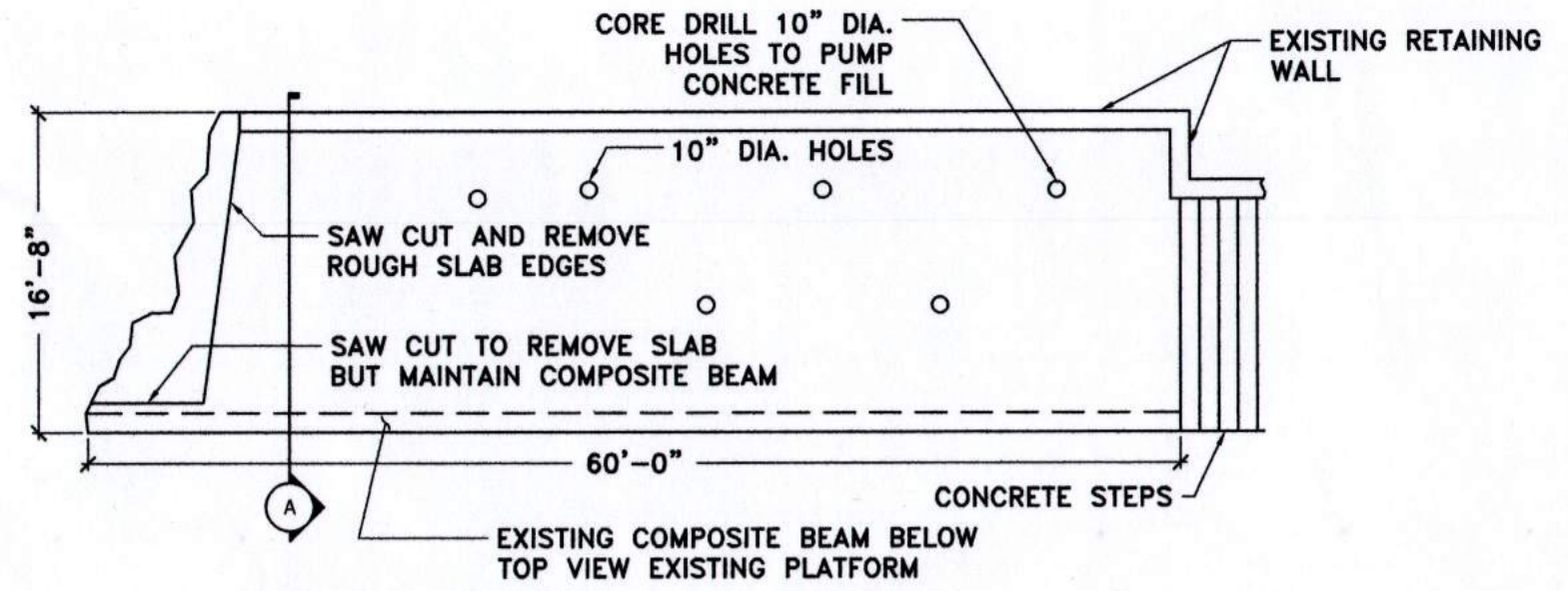

TOP VIEW EXISTING PLATFORM  
SCALE: NOT TO SCALE

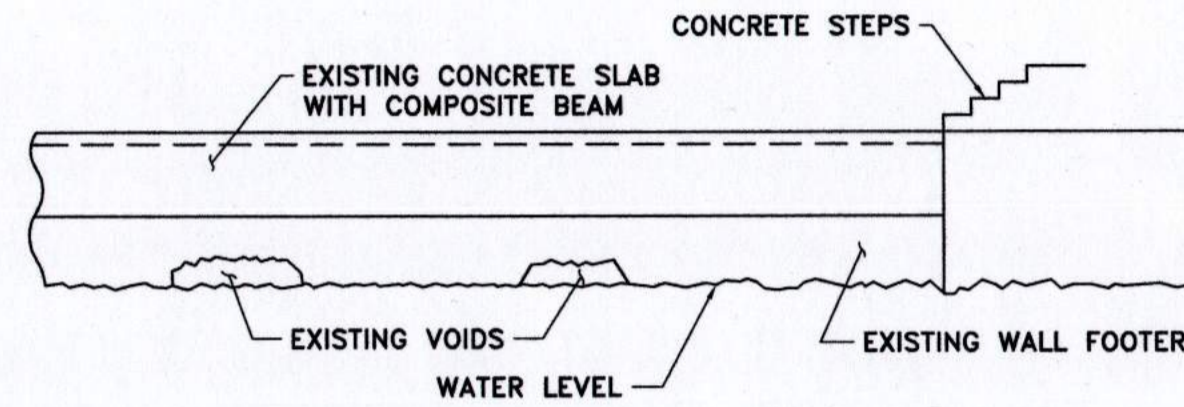

NORTH VIEW EXISTING PLATFORM  
SCALE: NOT TO SCALE

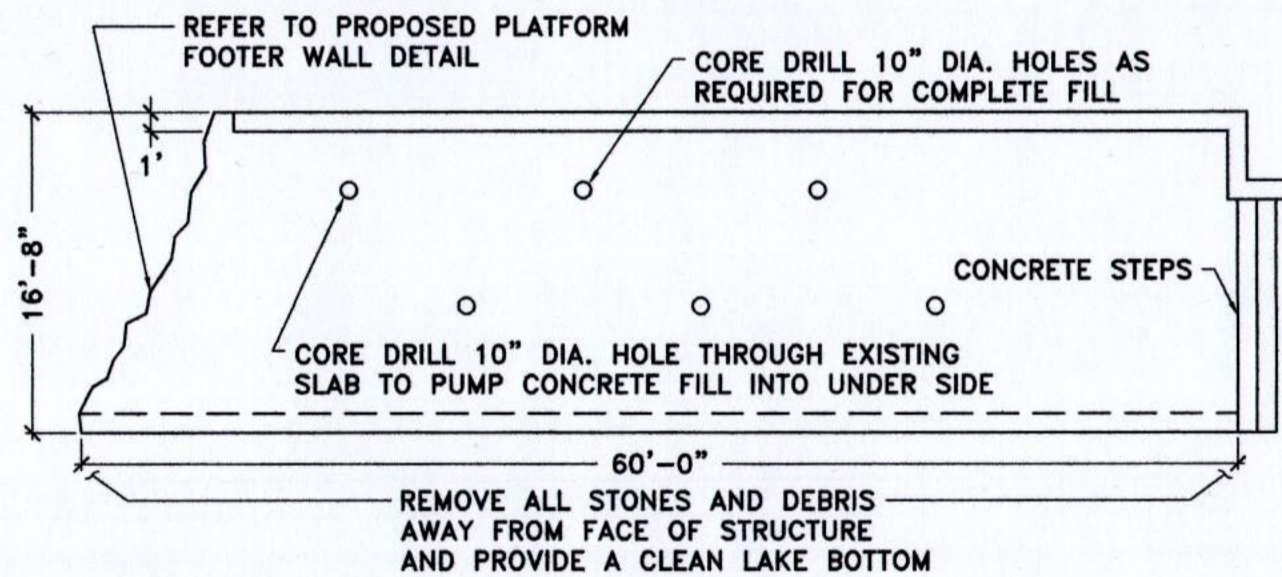

TOP VIEW PROPOSED PLATFORM PLAN DETAIL  
SCALE: NOT TO SCALE

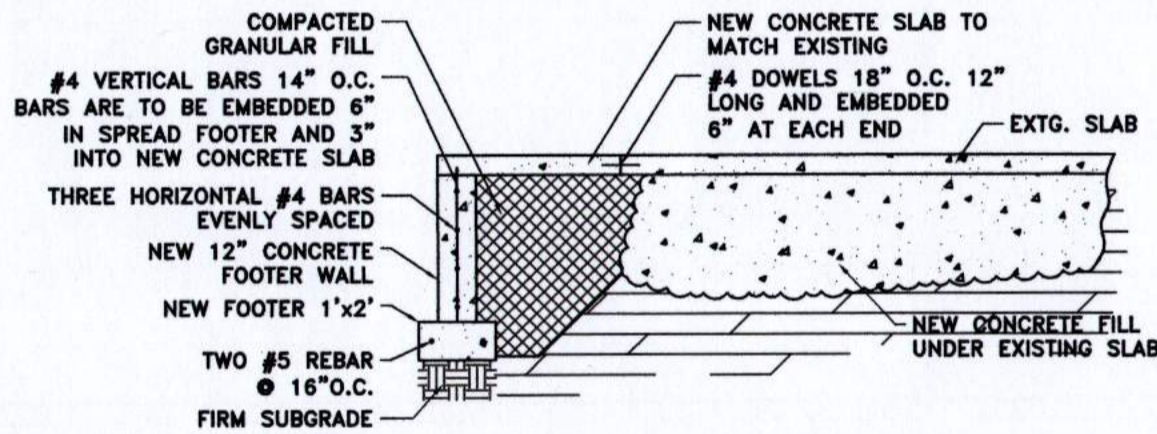

SECTION B  
SCALE: NOT TO SCALE

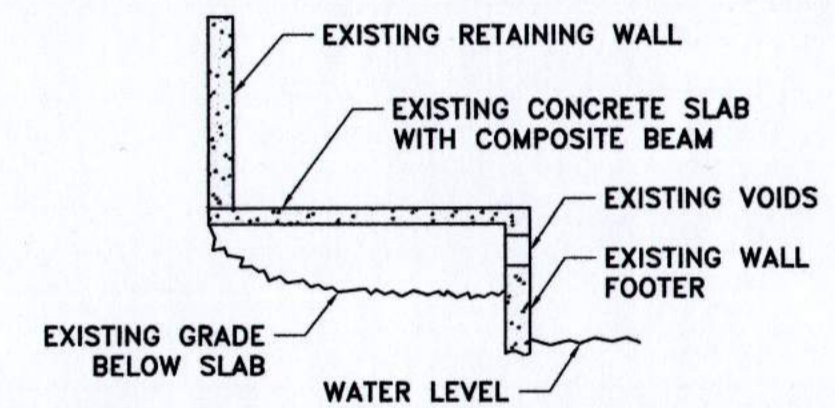

SECTION A-A  
SCALE: NOT TO SCALE

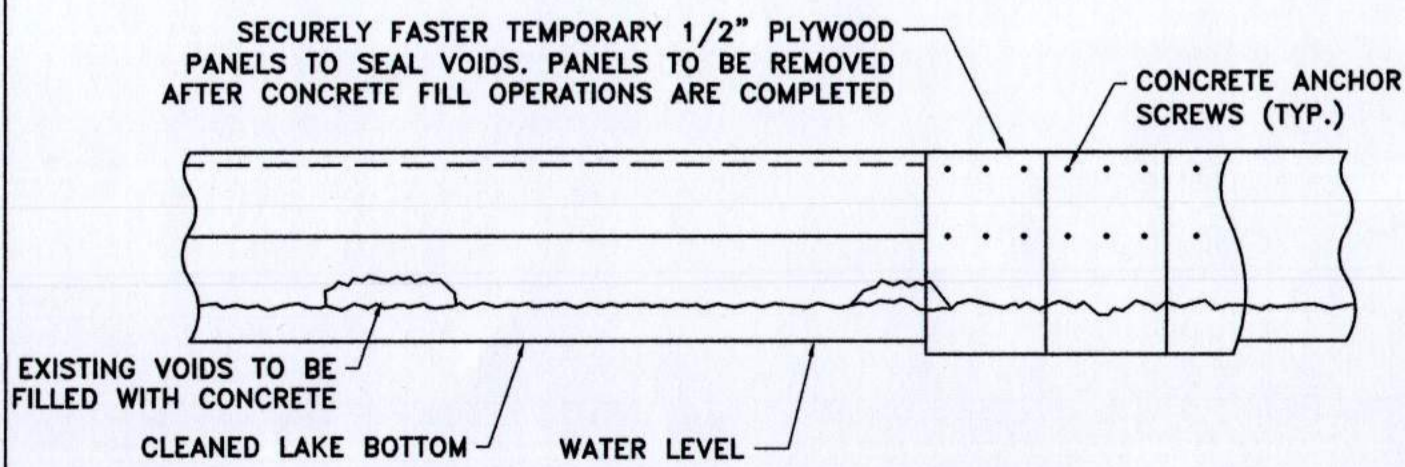

NORTH VIEW OF PLATFORM PLAN DETAIL  
SCALE: NOT TO SCALE

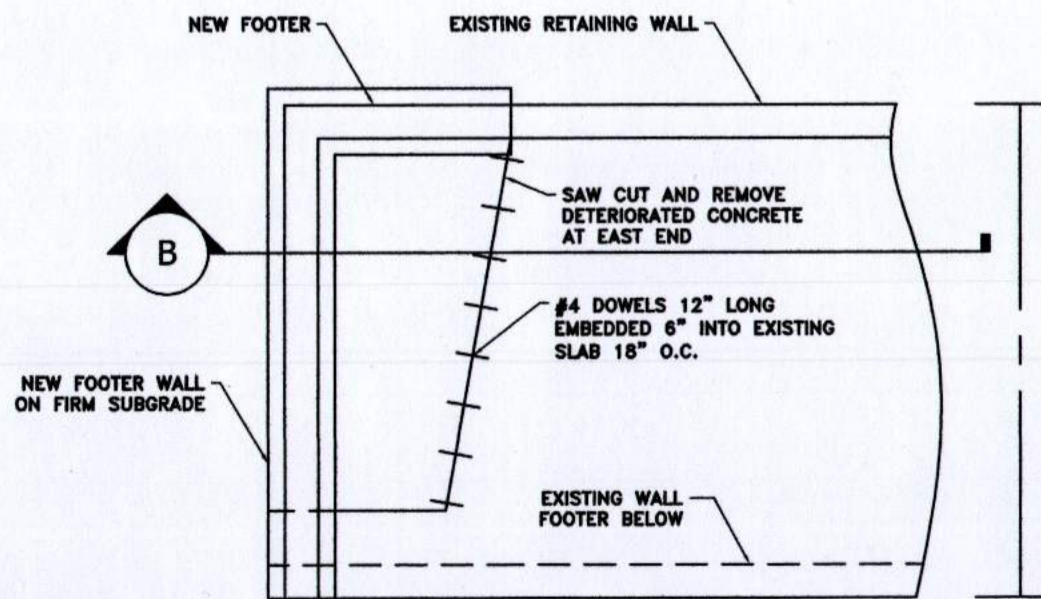

PROPOSED PLATFORM FOOTER WALL DETAIL  
SCALE: NOT TO SCALE

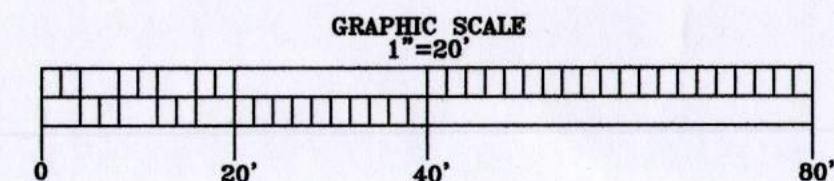

ERRORS & OMISSIONS:  
IF ANY ERRORS OR OMISSIONS APPEAR ON THE DRAWINGS THE CONTRACTOR SHALL IMMEDIATELY NOTIFY THE OWNER OR ENGINEER/ARCHITECT IN WRITING OF SUCH ERRORS OR OMISSIONS. THE DRAWINGS ARE A GUIDE, ANY WORK NOT INDICATED IN DRAWINGS, BUT NECESSARY TO COMPLETE THE ENTIRE WORK SHALL BE FURNISHED, PERFORMED, AND DONE AS IF THE SAME WERE INDICATED IN THE CONSTRUCTION DOCUMENTS. CONTRACTOR TO FIELD VERIFY ALL DIMENSIONS PRIOR TO CONSTRUCTION AND NOTIFY ENGINEER/ARCHITECT IMMEDIATELY OF ANY CONFLICTS.

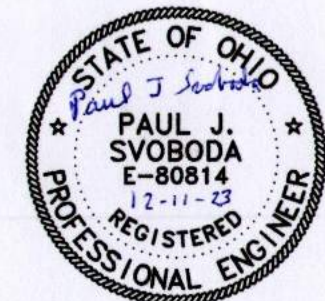
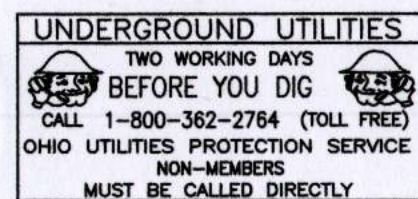

ENGINEERED TECHNICAL SOLUTIONS  
Site Design  
Erosion Control  
Ecological Utility

27930 Center Ridge Road  
Westlake, Ohio 44145  
Phone: (440) 899-6880  
www.egtechnicalsolutions.com

REVISIONS:	05-25-21	06-09-21	04-12-23	09-13-23
	05-27-21	06-25-21	06-30-23	09-27-23
	05-28-21	07-01-21	07-05-23	10-10-23
	06-01-21	07-05-21	07-28-23	12-09-23
	06-07-21	10-04-21	09-12-23	
VARIES	12-05-23			
R.S./A.M.				
J.A.S.				
PROJECT:	OAKWOOD BEACH ASSOCIATION	SCALE:		
	19590 FRAZIER DRIVE	DATE:		
LOCATION	ROCKY RIVER, OH 44116	DRAWN BY:		
		CHECKED BY:		

DWG. TITLE:  
EXTG. CONDITIONS  
& PROP.  
PLATFORM

DWG. NO.:  
EN-3  
ISSUE:  
PERMIT



**GENERAL NOTES:**

1. ALL ELEVATIONS REFERENCE IGLD 1985
2. PER USACE REQUIREMENTS 440 CUBIC YARDS OF SAND PRE-FILL FROM AN UPLAND SOURCE SHALL BE SIDECAST INTO THE LITTORAL DRIFT IN LESS THAN THREE FEET OF WATER, EITHER IMMEDIATELY EAST OR LAKEWARD OF THE PROJECT.
3. ALL SAND AND GRAVEL LOCATED BELOW THE PROPOSED FILL MATERIAL SHALL BE EXCAVATED AND SIDECAST INTO THE LITTORAL DRIFT IN LESS THAN THREE FEET OF WATER EITHER IMMEDIATELY EAST OR LAKEWARD OF THE PROJECT.

**UNDERGROUND UTILITIES**  
TWO WORKING DAYS BEFORE YOU DIG  
CALL 1-800-362-2764 (TOLL FREE)  
OHIO UTILITIES PROTECTION SERVICE  
NON-MEMBERS  
MUST BE CALLED DIRECTLY

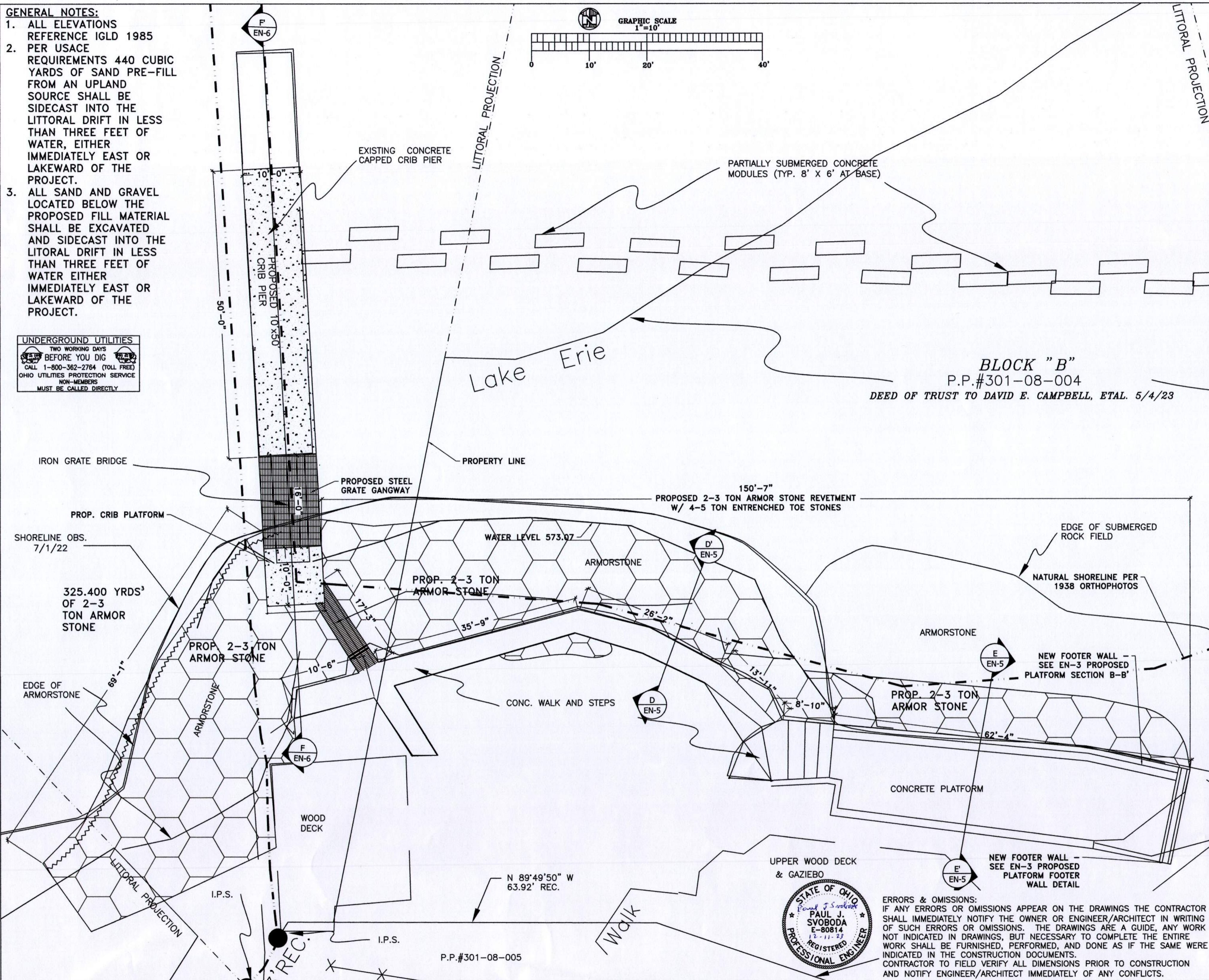

**BLOCK "B"**  
P.P.#301-08-004  
DEED OF TRUST TO DAVID E. CAMPBELL, ETAL. 5/4/23

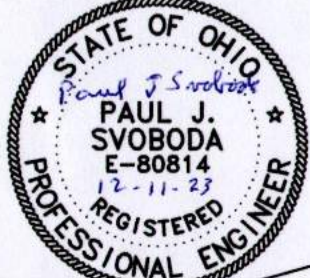

**ERRORS & OMISSIONS:**  
IF ANY ERRORS OR OMISSIONS APPEAR ON THE DRAWINGS THE CONTRACTOR SHALL IMMEDIATELY NOTIFY THE OWNER OR ENGINEER/ARCHITECT IN WRITING OF SUCH ERRORS OR OMISSIONS. THE DRAWINGS ARE A GUIDE, ANY WORK NOT INDICATED IN DRAWINGS, BUT NECESSARY TO COMPLETE THE ENTIRE WORK SHALL BE FURNISHED, PERFORMED, AND DONE AS IF THE SAME WERE INDICATED IN THE CONSTRUCTION DOCUMENTS. CONTRACTOR TO FIELD VERIFY ALL DIMENSIONS PRIOR TO CONSTRUCTION AND NOTIFY ENGINEER/ARCHITECT IMMEDIATELY OF ANY CONFLICTS.

**ENGINEERED TECHNICAL SOLUTIONS**  
Site Design  
Erosion Control  
Ecological Utility  
27330 Center Ridge Road  
Westlake, Ohio 44145  
Phone: (440) 899-6880  
www.engineeredtechnical.com

REVISIONS:	05-25-21	06-09-21	04-12-23	09-13-23
	05-27-21	06-25-21	08-30-23	09-27-23
	05-28-21	07-01-21	07-08-23	10-10-23
	06-01-21	07-05-21	07-28-23	12-08-23
	06-07-21	10-04-21	09-12-23	
SCALE:	1"=10'			
DATE:	12-05-23			
DRAWN BY:	R.S./A.M.			
CHECKED BY:	J.A.S.			
PROJECT:	OAKWOOD BEACH ASSOCIATION			
	19590 FRAZIER DRIVE			
LOCATION:	ROCKY RIVER, OH 44116			

DWG. TITLE:  
**PROPOSED PLAN**

DWG. NO.:  
**EN-4**  
ISSUE:  
**PERMIT**



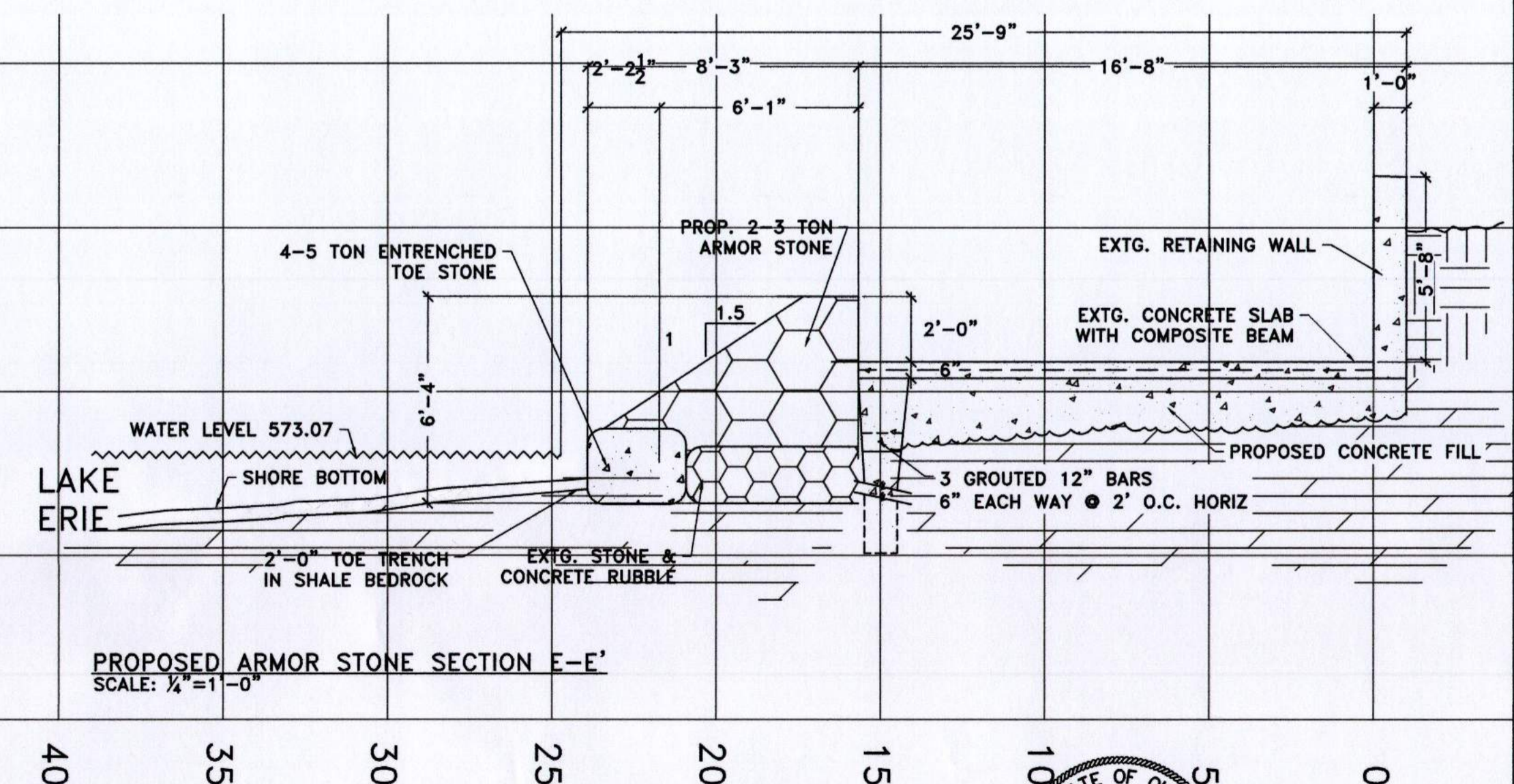
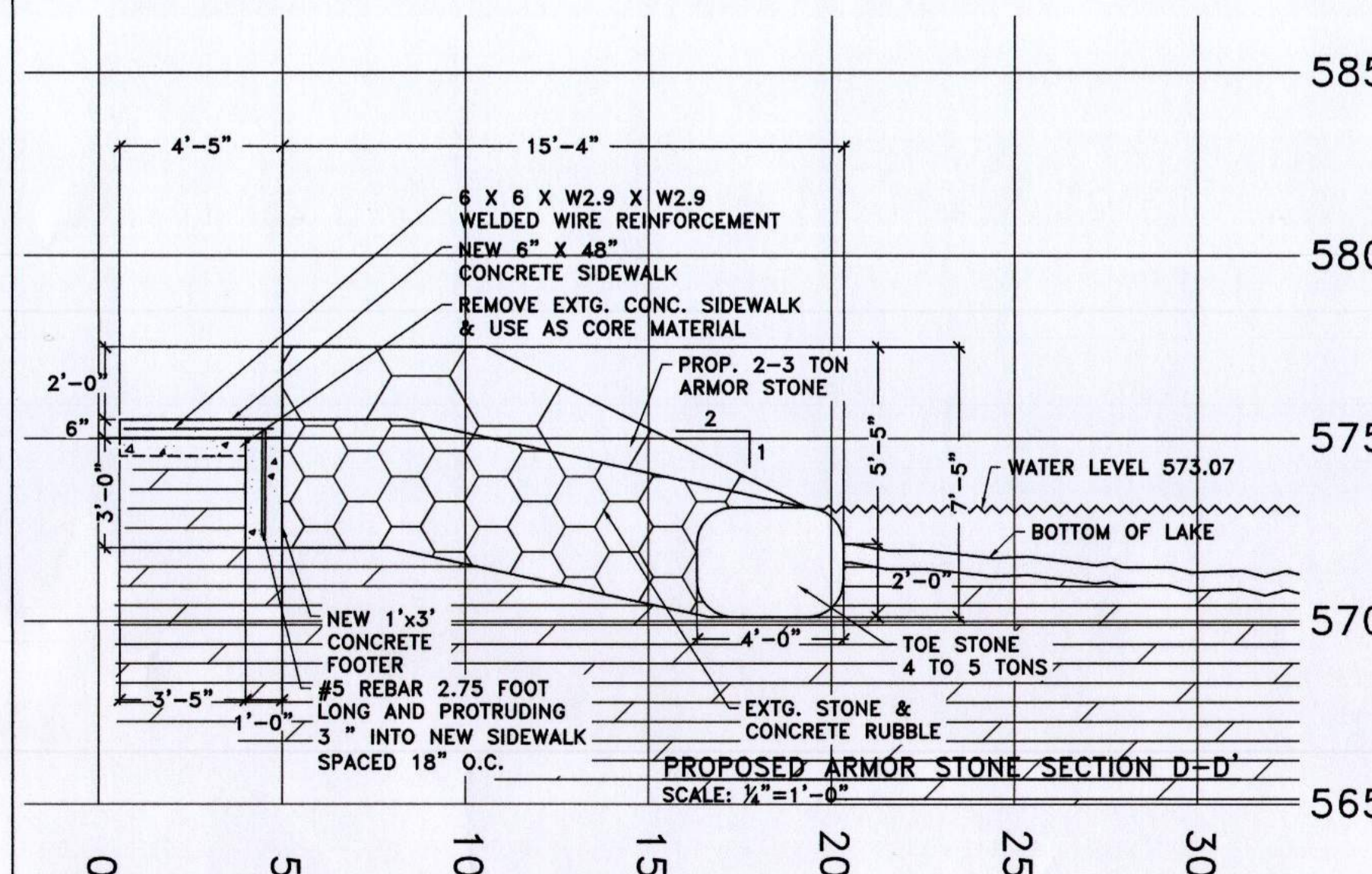
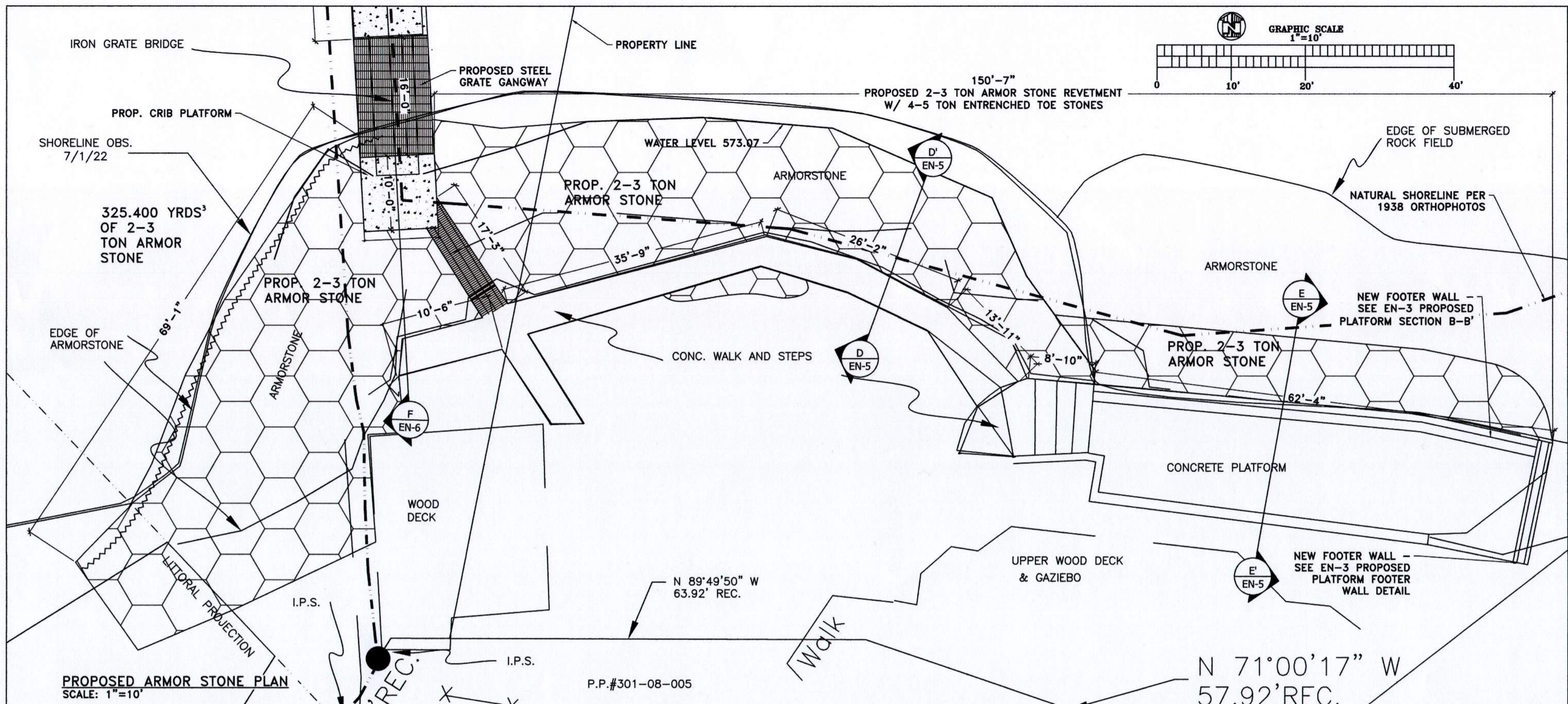

**ERRORS & OMISSIONS:**  
IF ANY ERRORS OR OMISSIONS APPEAR ON THE DRAWINGS THE CONTRACTOR SHALL IMMEDIATELY NOTIFY THE OWNER OR ENGINEER/ARCHITECT IN WRITING OF SUCH ERRORS OR OMISSIONS. THE DRAWINGS ARE A GUIDE, ANY WORK NOT INDICATED IN DRAWINGS, BUT NECESSARY TO COMPLETE THE ENTIRE WORK SHALL BE FURNISHED, PERFORMED, AND DONE AS IF THE SAME WERE INDICATED IN THE CONSTRUCTION DOCUMENTS. CONTRACTOR TO FIELD VERIFY ALL DIMENSIONS PRIOR TO CONSTRUCTION AND NOTIFY ENGINEER/ARCHITECT IMMEDIATELY OF ANY CONFLICTS.

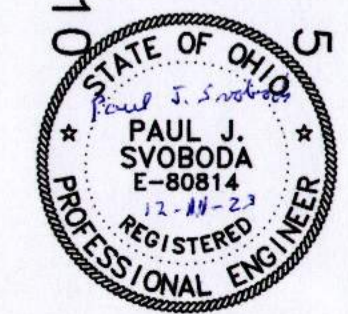
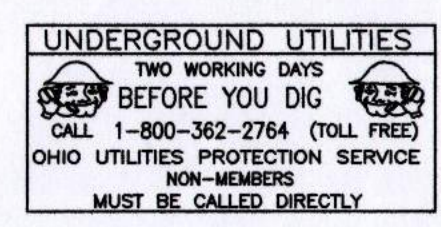

**ENGINEERED TECHNICAL SOLUTIONS**  
Site Design  
Erosion Control  
Ecological · Utility

27330 Center Ridge Road  
Westlake, Ohio 44145  
Phone: (440) 899-6880  
www.engtechsolutions.com

REVISIONS:	VARIES	SCALE:	DATE:	DRAWN BY:	CHECKED BY:
05-25-21	06-09-21	04-12-23	09-15-23		
05-27-21	06-25-21	06-30-23	09-27-23		
05-28-21	07-01-21	07-05-23	10-10-23		
06-01-21	07-05-21	07-28-23	12-09-23		
06-07-21	10-04-21	08-12-23			

**PROJECT:**  
OAKWOOD BEACH ASSOCIATION  
19590 FRAZIER DRIVE  
LOCATION  
ROCKY RIVER, OH 44116

**DWG. NO.:** EN-5  
**ISSUE:** PERMIT